

# PARTS CATALOG

KM186

## KIPOR

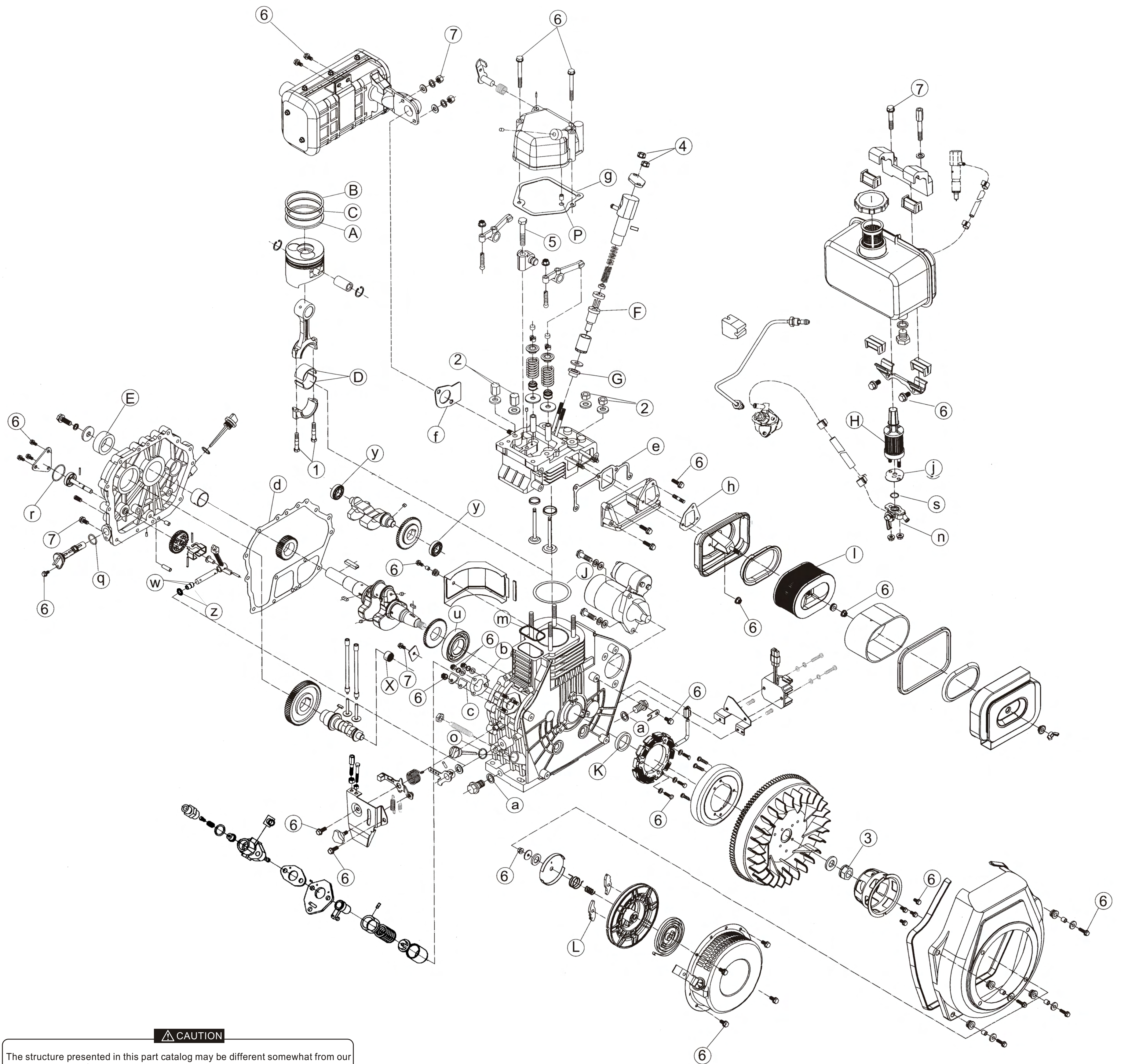

### CAUTION

The structure presented in this part catalog may be different somewhat from our improved types in future.  
Then you'd better refer parts catalog to the operation manual when using.

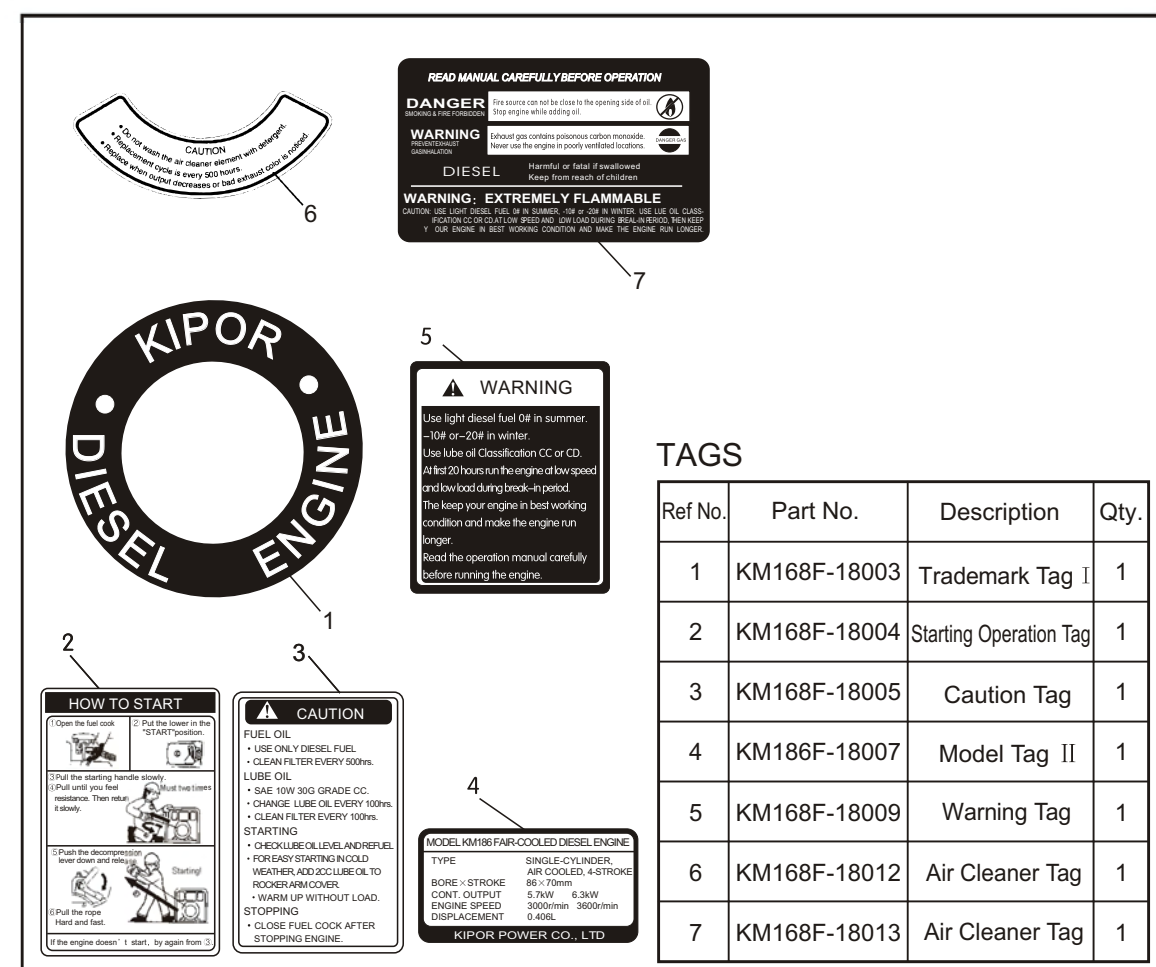

### EASY DESTROYED PARTS

Ref No.	Part No.	Description	Qty.	Mounted to
A	KM186F-04100	Oil Ring Unit	1	(4)Piston & Connecting Rod Assem.
B	KM186F-04001	First Air Ring	1	(4)Piston & Connecting Rod Assem.
C	KM186F-04002	Second Air Ring	1	(4)Piston & Connecting Rod Assem.
D	KM186F-04005	Connecting Rod Bushing	2	(4)Piston & Connecting Rod Assem.
E	GB/T9877.1-1988	Oil Seal Sg30 × 50 × 8	1	(1)Cylinder Block Assem.
F	KM186F-13100	Nozzle	1	(8)Fuel Injection Valve Assem.
G	KM186F-02011	Heat Insulator	1	(2)Cylinder Head Assem.
H	KM186F-10300	Element Unit	1	(11)Fuel System
I	KM186F-07100	Air Cleaning Element Unit	1	(7)Air Intake System
J	KM186F-01013	Cylinder Head Gasket	1	(1)CylinderBlock Assem.
K	GB/T9877.1-1988	Oil Seal Sg30 × 50 × 8	1	(1)CylinderBlock Assem.
L	KM186F-14008	Starter Ratchet	2	(14)Manual Starting Assem.

### O-RINGS

Ref No.	Part No.	Description	Qty.
m	KM186F-01008	Sheet Gasket	1
n	GB/T1235-1976	O-Ring 11 × 1.9	1
o	GB/T1235-1976	O-Ring 22.5 × 2.4	2
p	GB/T1235-1976	O-Ring 12 × 1.9	1
q	GB/T1235-1976	O-Ring 25 × 2.4	1
r	GB/T3452.1-1992	O-Ring 34 × 1.8	1
s	GB/T3452.1-1992	O-Ring 13.2 × 1.8	1

### FASTENING TORQUE OF MAIN BOLT&NUT Unit: N.m

Ref No.	Description	Torque
①	Connecting Rod Nut	38~42
②	Cylinder Head Nut	54~58
③	Flywheel Nut	130~150
④	Nozzle Retainer Nut	10~12
⑤	Set Bolt of Rocker Arm Seat	43~47
⑥	Standard Bolt / Nut M6	10~12
⑦	Standard Bolt / Nut M8	18~20

### BEARING

Ref No.	Part No.	Description	Qty.
U	GB/T276-1994	Ball Bearing 6308/P5	1
w	GB/T290-1989	Needle Bearing 7941/8	2
x	GB/T290-1989	Needle Bearing HK1512	1
y	GB/T276-1994	Ball Bearing 6203/P5	2

### OIL SEAL

Ref No.	Part No.	Description	Qty.
z	KM168F-11008	Lever Shaft Oil Seal	1

### WASHER KIT

Ref No.	Part Number	Description	Qty.
a	KM168F-01100	Washer Unit of Drain Plug	2
b	KM168F-10014	Fuel Injection Pump Washer	2~3
c	KM168F-10016	Joint Washer	1
d	KM168F-01015	Crankcase Cover Washer	1
e	KM186F-02014	Intake Pipe Washer	1
f	KM186F-02015	Exhaust Pipe Washer	1
g	KM186F-03003	Cylinder Head Cover Washer	1
h	KM186F-07001	Air Cleaner Washer	1
j	KM168F-10007	Fuel Filter Washer	1

**KIPOR POWER CO., LTD.**

11/F Suntime International Mansion, 450 Fushan Road, Pudong, Shanghai, China  
TEL: 86-21-58208881 FAX: 86-21-58208877



